

Wegwerp mondmasker

Masque facial jetable

Disposable face mask

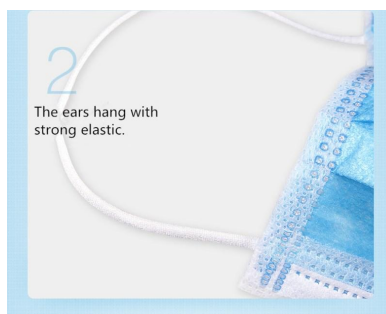

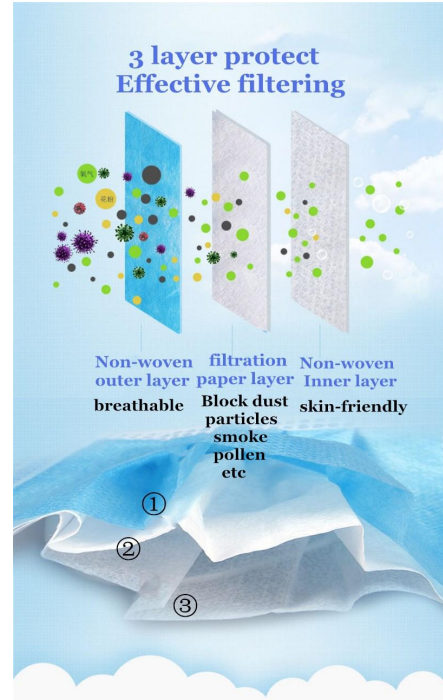
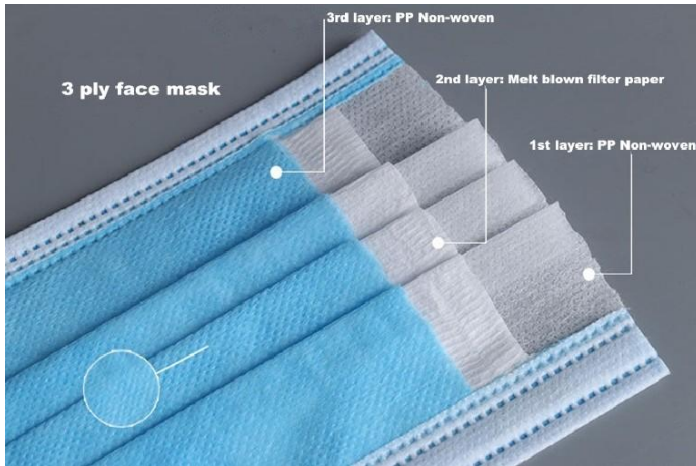

Item name	Medical Face Masks
Style	With elastic ear loops
Material	1st layer : pp 20g 2nd layer : 20—25g 3rd layer : PP 20g/ES20g
Size	17.5 x 9.5 cm (adult)
Colour	blue
Certificate	CE, FDA, ISO13485, SGS, TUV
Standard	1、 BFE ≥99% ; Bacterial Filtration Efficiency 2、 PFE ≥99% ; Particle Filtration Efficiency (0,1 micron) 3、 Polypropylene inner and outer facing assures comfortable on the inside and protection on the outside 4、 Conform with ASTM F2100 level1 (Staphylococcus aureus aerosol) 5、 Conform with EN14683 Type 2